

GOLF CART BATTERIES

Only-electric vehicle or all-electric vehicle is a type of electric vehicle (EV) that exclusively uses chemical energy stored in rechargeable battery packs, with no secondary source of propulsion (eg. hydrogen fuel cell, internal combustion engine, etc.). BEVs use electric motors and motor controllers instead of internal combustion engines (ICES) for propulsion. They derive all power from battery packs and thus have no internal combustion engine, fuel cell or fuel tank. BEVs include motorcycles, bicycles, scooters, golf carts, railcars, aerial work platforms, forklift, buses, trucks and cars.



Model	Capacity of 27 C(80 F) when discharged upto 1.75V/cell AMP-HOURS (Ah)			Normal Voltage (Volts)	DIMENSIONS (MM)			Approx. Battery Weight (Kgs)		Electrolyte Volume(Ltrs)
	5-Hr RATE	10-Hr RATE	20-Hr RATE		LENGTH	WIDTH	HEIGHT	dryt weight	Wet weight	
6C 225	185	207	225	6	260	180	277	22	30	6.5
6C 370	303	340	370	6	312	180	370	30.5	43.5	10
8C 150	114	130	150	8	260	180	277	20	28	6.5
12C 130	105	120	130	12	346	173	296	30	42	9.6



CHARGING INSTUCTIONS

CHARGER VOLTAGE SETTINGS (@ 27°C

SYSTEM VOLTAGE	6V	8V	12V
Bulk Charge	7.35	9.88	14.70
Float Charge	6.75	9.00	13.50
Normal Charge	8.01	10.68	16.02

WARRANTY : ONE YEAR

TERMINAL CONFIGUARATION (6 V–225 Ah / 8 V–170Ah / 12V–130Ah) Embedded Terminal

Terminal Height – 30 mm

Bolt – 08 mm

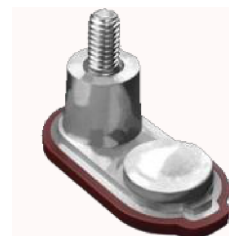

	State of charge Measure of open circuit voltage				
Charging Temperature Compensation Add 0.005 volt per cell for every 1°C below 27°C Subtract 0.005 volt per cell for every 1°C above 27°C Operational Data Operating Temp. -20°C below 55°C At Temp. below 0°C maintain a State of charge > 60% Self-Discharge 2 – 10% per month depending on storage temp. conditions	% of Charge	Specific Gravity	6 Volt	8 Volt	12 Volt
	100	1.280	6.36	8.48	12.72
	90	1.260	6.31	8.41	12.62
	80	1.240	6.26	8.34	12.52
	70	1.220	6.20	8.27	12.40
	60	1.195	6.13	8.17	12.26
	50	1.170	6.06	8.08	12.12
	40	1.150	5.99	7.98	11.98
	30	1.125	5.92	7.89	11.84
	20	1.100	5.84	7.78	11.68
	10	1.075	5.75	7.67	11.50

SPECIAL FEATURES:

- Deep-Cycle Flooded/Wet Lead Acid Battery
- Low maintenance
- Corrosion resistant
- Heavy duty custom made separators
- Heat sealed to avoid container leakage
- Available in range of 6 & 8 and 12 volts configuration

CARING FOR YOUR GOLF CART BATTERY

- **Overcharging damages cells:** Try to use automatic chargers that switch off once the battery reaches its maximum charge.
- **Check water levels each month:** Level checks are particularly easy with batteries, as the easy flip top is simple to open.
- Always use distilled water
- **Take preventative measures:** Applying thin layer of petroleum jelly will protect your battery terminal from corrosion.
- Ensure all users switch off electrical items such as light bulbs, or other electronic devices that can drain the batteries.
- For businesses in the hospitality industry, providing user instructions will help ensure proper use.
- Always switch off the power from the golf cart before storing it.
- Remember that the harder the battery has to work, the quicker it will discharge. If a golf course or location has lots of steep hills, try to avoid the obstacle in the area for a more comfortable drive to use less battery power.

